



**aqualytic**™  
Laboratory & Environmental

# Enumeration of Somatic Coliphages

According to the ISO 10705-2 method



## Easy kit for 1 mL

All types of water: Raw and treated wastewater, surface water, recreational water, shellfish extracts, sediments and sludge extracts after dilution where necessary

### BP1601

Sample Volume 1 mL  
70 assays  
MSA and MSB ready to use  
Strain and positive control included

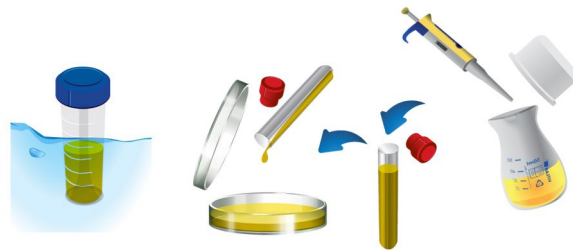

## Easy kit for 100 mL

Based on ISO method 10705-2, ideal for drinking water analysis

### BP1604

Sample Volume 100 mL  
10 assays  
MSA and MSB ready to use  
Strain and positive control included



## Biological material

### BP1603:

Host strain *E. coli* WG5 10 units  
Virus bacteriophage  $\phi$ X174 10 units

### BP1628:

Host strain *E. coli* WG5 20 units

### BP1626:

Virus bacteriophage  $\phi$ X174 20 units

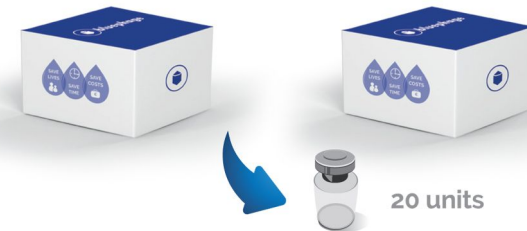

## Powder media:

### BP1638 Modified Scholten's Agar (MSA)

Solid culture medium used as a basal layer in the enumeration of somatic coliphages.  
500 g (for 550 plates approximately)

### BP1637 Modified Scholten's Broth (MSB)

Culture broth used for the enumeration of somatic coliphages. 500 g

